

## QWT650-L WR-650

Features:  
\* Low VSWR

Applications:  
\* Transmitters  
\* Antennas  
\* Laboratory Test  
\* Impedance Matching

### Electrical

Frequency: 1.13~1.73GHz  
VSWR: 1.03 max.

### Mechanical

Waveguide Size: WR-650 (BJ14)  
Flange: FDP14

### Environmental

Temperature: -55~+125°C

### Outline Drawings

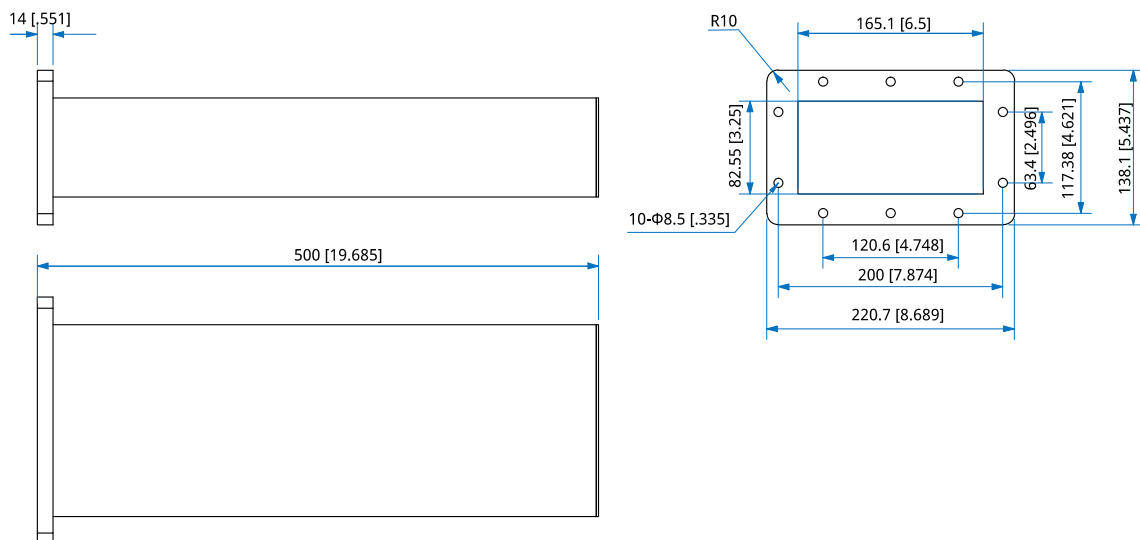

Outline A

Unit: mm [in]

Tolerance:  $\pm 0.5\text{mm}$  [ $\pm 0.02\text{in}$ ]

### How To Order

**QWT650-L-Y-Z**

Y : Material

Z : Flange type

Material naming rules:

A - Aluminum (Outline A)

Flange naming rules:

2 - FDP14 (Outline A)

Examples:

To order a low power waveguide termination, WR-650, low power, Aluminum, FDP14, specify QWT650-L-A-2.

Customization is available upon request.